

## Good-looking , Stable , Easy to use

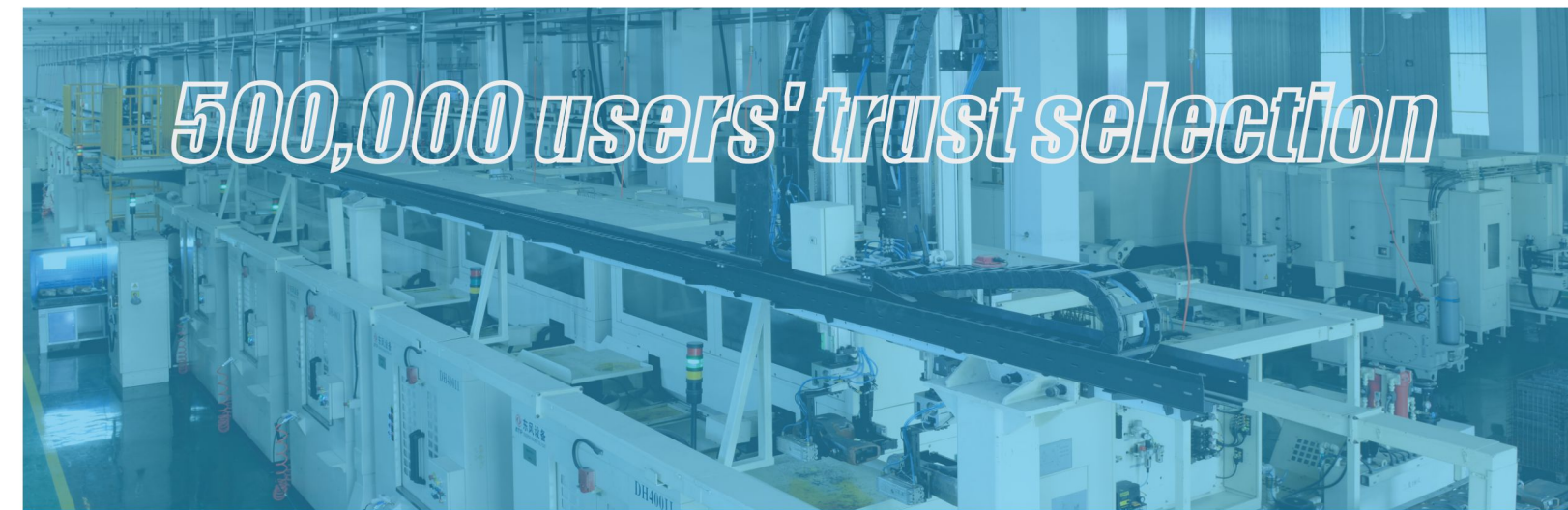

German design, Unique vision

				(mm)	(mm)	(mm)		(mm)	(S.p.m)	(mm)	NW/GW	(kg)	
E4-2	11#	1	2	/	/	3.8	0.7-2	4.5	5500	525×360×510	27.9/35.88		
E4-02×250	14#	2	4	5	24	3.8	0.7-2	5	5500	525×360×510	27.9/35.88		
E4WF-3-02/213	11#	1	3	/	4	3.8	0.7-2	5	5500	525×360×510	27.9/35.88		
E4-3-02/233	11#	1	3	/	4	3.8	0.7-2	5	5500	525×360×510	27.9/35.88		
E4-3-12/233	11#	1	3	/	4	3.8	0.7-2	5.5	5500	525×360×510	27.9/35.88		
E4-3-32R2/223	9#	1	3	/	1.5	3.8	0.7-2	5	5500	525×360×510	27.9/35.88		
E4-3-82/233	11#	1	3	/	4	3.8	0.7-2	5	5500	525×360×510	27.9/35.88		
E4-4-83/323	11#	2	4	2	4	4.2	0.7-2	5.5	5500	525×360×510	27.9/35.88		
E4-4-M03/333	11#	2	4	2	4	4.6	0.7-2	6	5500	525×360×510	27.9/35.88		
E4-4-M03/333/H/M	11#	2	4	2	4	4.6	0.7-2	6	5500	525×360×510	27.9/35.88		
E4-5-02A/233	11#	2	5	3	4	3.8	0.7-2	5	5500	525×360×510	27.9/35.88		
E4-5-03/233 (5×5)	14#	2	5	5	5	3.8	0.7-2	5	5500	525×360×510	27.9/35.88		
E4-5-03/333 (3×4)	14#	2	5	3	4	3.8	0.7-2	5	5500	525×360×510	27.9/35.88		
E4-5-A04/435	19#	2	5	5	6	5	0.8-1.5	7	5500	525×360×510	27.9/35.88		
E4-6-03/333	11#	3	6	3×2	4	3.8	0.7-2	5	5500	525×360×510	27.9/35.88		



power saving leader



E4

### Advanced Mechanical Platform, Mechatronics Technology



With improved and advanced platform, E4 completely integrates servo motor, control box and panel into the machine head, which gives unique and extraordinary vision.

### Intelligent Functions, Smart Panel



With smart dormancy function, machine will enter into dormant state if stop running more than 30 min;  
 "J2" - easily to know the energy consumption;  
 "Eb" - avoid to suffer the high voltage shock if more than 274V;  
 With smart panel, it's easier for speed adjusting, needle position and reset.

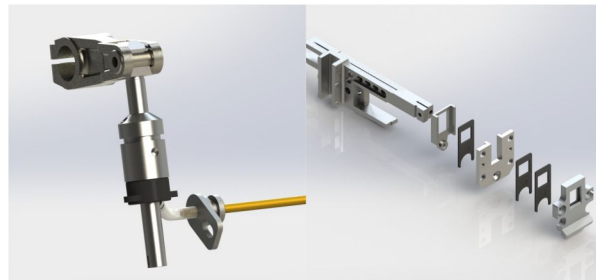

### Integrated Oil System, Avoiding Oil Leakage

Enclosed needle bar mechanism with integrated oil-filtering, oil-supplying and oil-returning system avoids oil leakage.

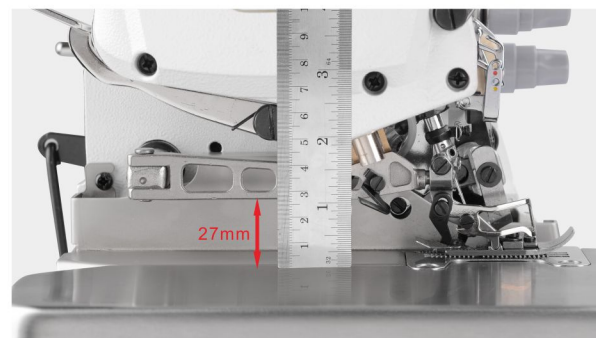

### Larger Feeding Space

Presser foot height increases to 27mm, ensures larger feeding space.



### Suitable For Different Materials

Heavy and light materials can be sewing smoothly.

### Power Consumption Comparison-Standby Condition

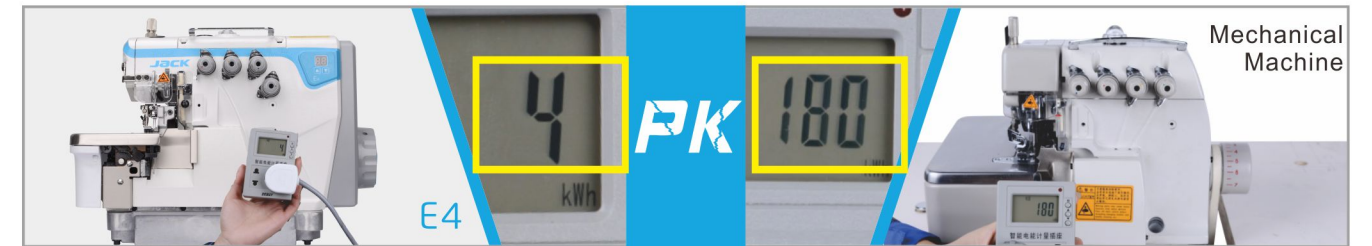

### Power Consumption Comparison-Working Condition



MODEL	electronic fee	working power	Standby power	working time	Standby time	kilowatt hour	charge
E4	1RMB	238W	4W	4H	4H	0.968	<b>0.97RMB</b>
CLUTCH MOTOR		446W	180W	4H	4H	2.504	<b>2.50RMB</b>

300DAY : (2.50-0.97)X300 = **459RMB**



Three years warranty for control box



### Mechanical Machine

high cost

Clutch motor spare parts Bearings Pulley & Belt

